

● Features:

Output current in excess of 150 mA No external components required Internal short circuit current limiting
 Internal thermal overload protection Available in either 5% selections

● Electrical Characteristics (Ta=25°C)

Parameter	Symbol	Ratings	Unit
Input voltage (TA=25°C)	Vi	35	V
Output current	Io	0.15	A
Power dissipation (TA=25°C)	P _D	0.5	W
Ambient temperature	T _{OP}	-40~85	°C
Storage Temperature	T _{stg}	-55~150	°C

Three-terminal fixed output voltage regulator
 0.5W, 0.15A, 5V

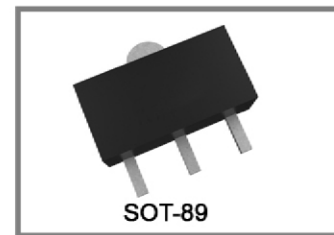

Main purposes:

the role of regulator and protection for a variety of electrical appliances, electronic equipment, regulator circuit

● Electrical characteristics (Unless otherwise specified) Vi=10V, Io=40mA, Ci=0.33μF, Co=0.1μF

Parameter	Symbol	Test Conditions	Min	Typ	Max	Unit	
Output voltage	Vo	Tj=25°C	4.75	5	5.25	V	
		1mA ≤ Io ≤ 40mA, 7V ≤ Vi ≤ 20V	4.65	5	5.35		
Voltage Regulation	Sv	Tj=25°C	7V ≤ Vi ≤ 20V	—	—	150	mV
			8V ≤ Vi ≤ 20V	—	—	100	
Current Regulation	Si	Tj=25°C, 1mA ≤ Io ≤ 100mA	—	—	60	mV	
Quiescent Current	Iq	Tj=25°C	—	—	6	mA	
Quiescent Current Change	ΔIq	1mA ≤ Io ≤ 40mA	—	—	0.1	mA	
		8V ≤ Vi ≤ 20V	—	—	1.5		
Input - output differential pressure	Vi - Vo	Tj=25°C	—	1.7	—	V	
Ripple Rejection Ratio	Srip	Tj=25°C, 8V ≤ Vi ≤ 18V, f=120Hz	—	49	—	dB	

SOT-89 Dimensions

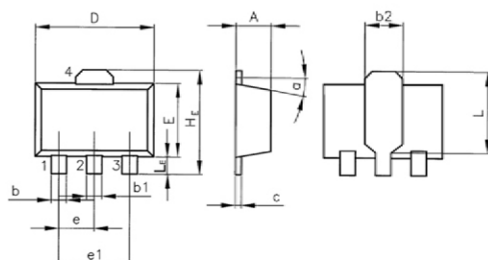

1 OUT 2 GND 3 IN 4 GND

Unit: mm

Size Symbol	SOT-89			Size Symbol	SOT-89		
	min	typ	max		min	typ	max
A		1.5		e		1.5	
b			0.65	e1		3	
b1			0.65	HE			4.25
b2		1.6		L	2.6		2.95
c	0.25			LE	0.8		1.2
D		4.5		α			10°
E			2.6				

SK MAKE CONSCIOUS PRODUCT

CONSCIOUS PRODUCTS BEGIN WITH CONSCIOUS PEOPLE

